

1 square = 0.5 cm^2

← 155 cm →

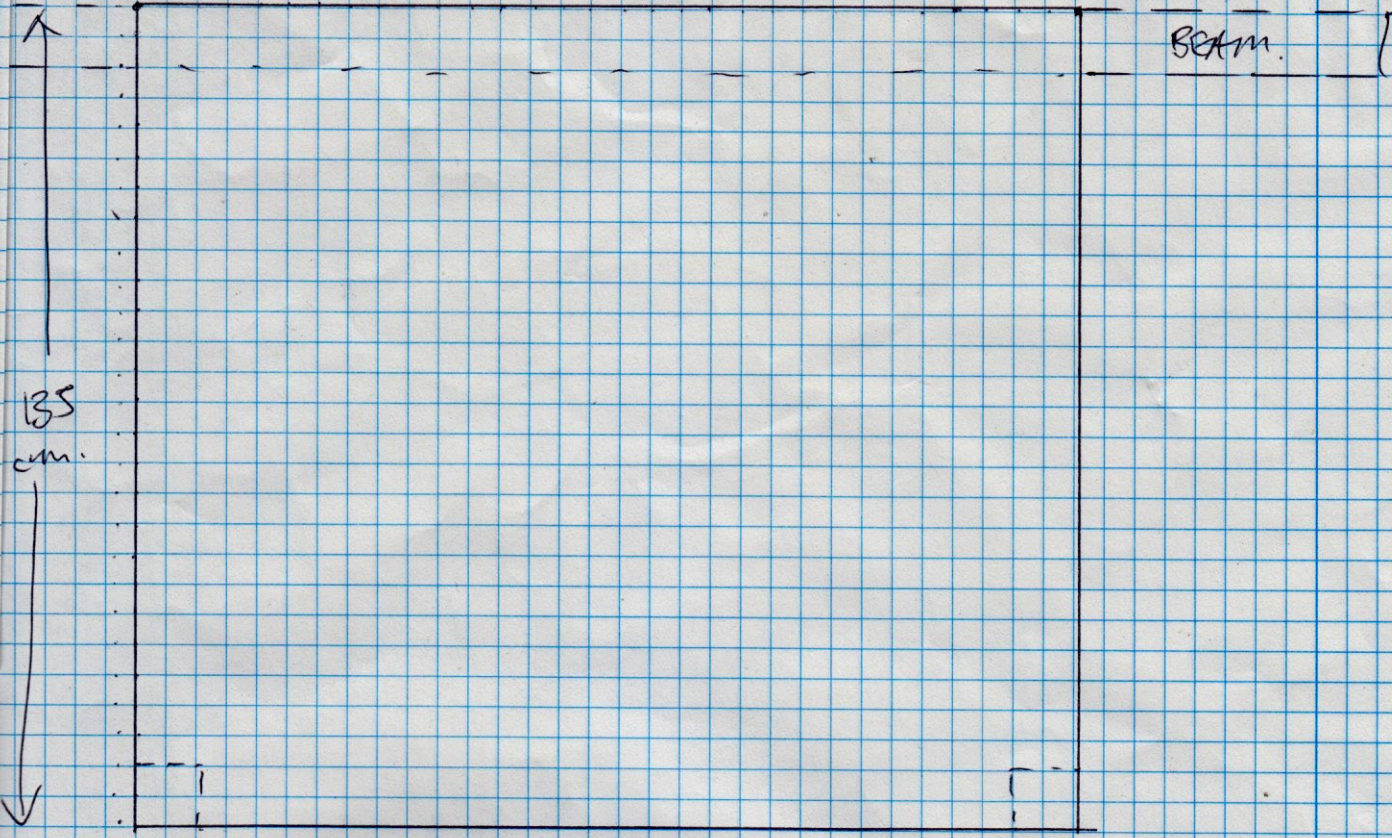

135
cm.

Beam

1mm = 1cm

timber 4.5 x 8.5cm

Window proportional to door

Put in door frame so it sticks out half way (4.25cm) to help make door proud of top (can attach extra bit of wood)

Wide side outside!

This piece have 8.5cm on front. sides front.

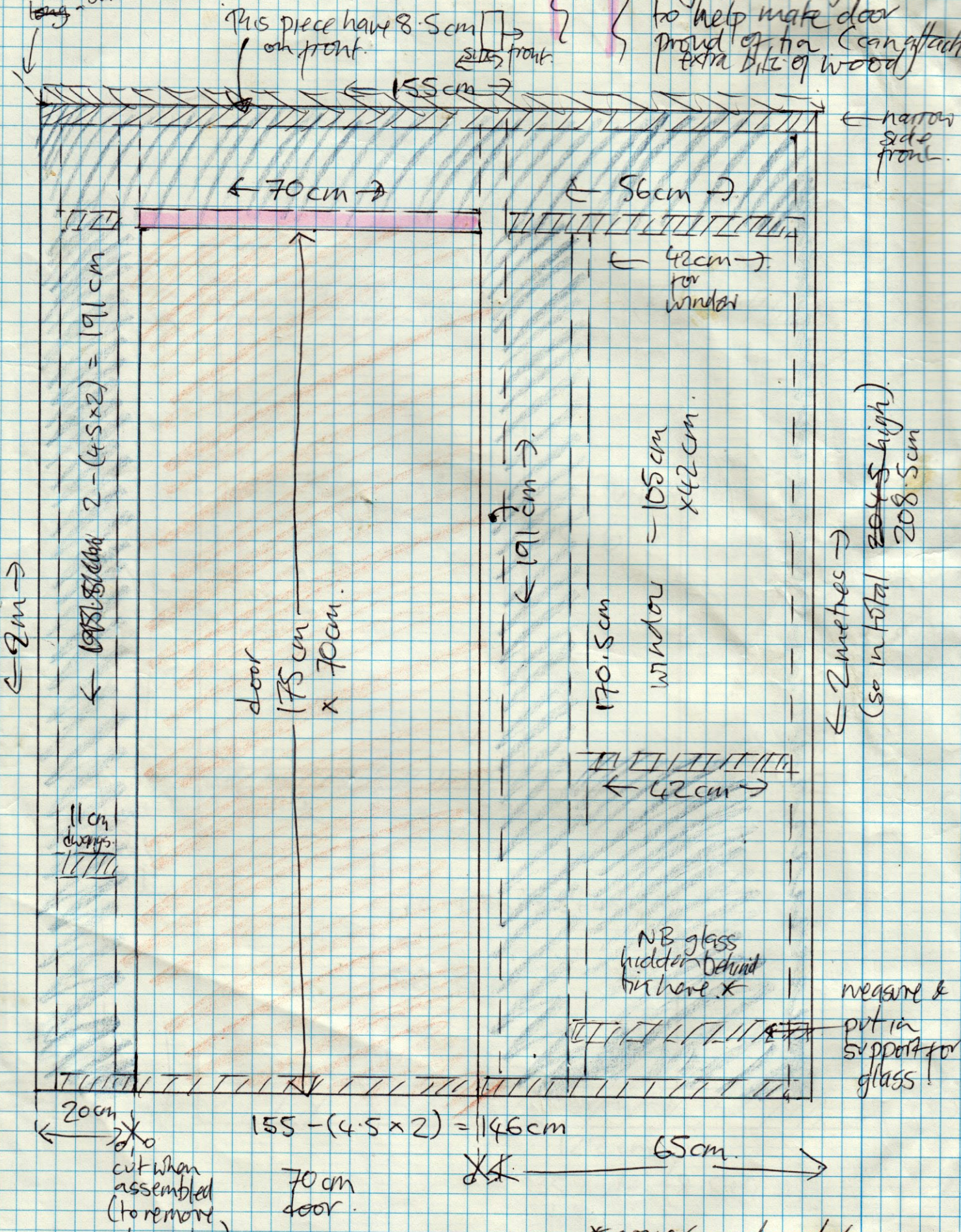

narrow side front.

11cm display

x 2
(reversed)

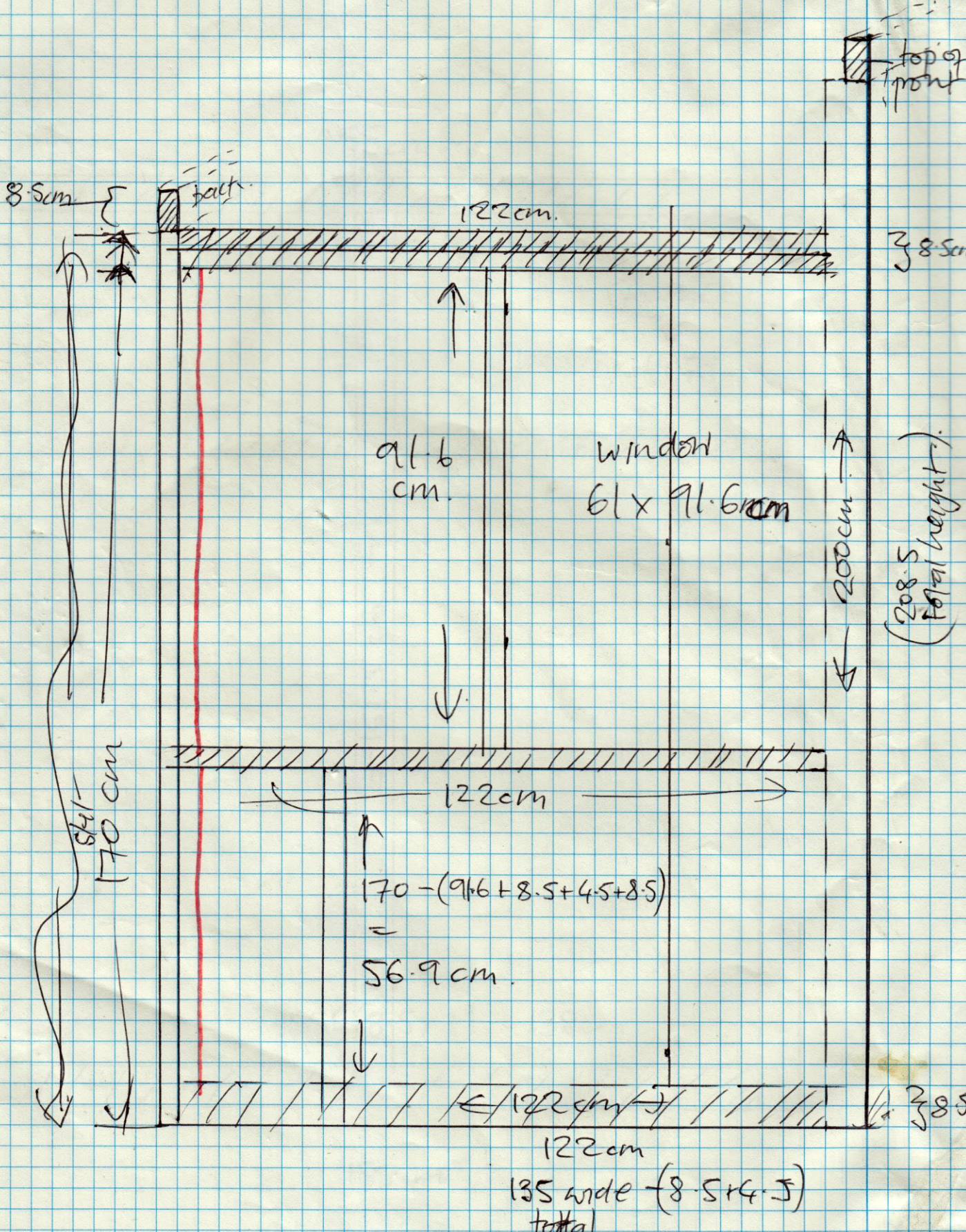

Rect:

